



## **Brown County Cold Mix Asphalt Pricing**

**4/15/19**

### **EZ Street High Performance Cold Asphalt**

**\$100 price per ton for all precincts if picked up at the JLB Plant at 7151 Randol Mill Rd. Fort Worth, TX. 76124**

**No Minimum.**

### **Precinct 1 -**

**\$127 price per ton delivered to 3606 HWY 377 S Brownwood, TX.**

**(Based on 25 ton load - 150 miles at \$4.50 per mile)**

### **Precinct 2 -**

**\$125 price per ton delivered to 3601 FM 1689 May, TX.**

**(Based on 25 ton load - 141 miles at \$4.50 per mile)**

### **Precinct 3 -**

**\$126 price per ton delivered to 1951 CR 381 Early, TX.**

**(Based on 25 ton load - 146 miles at \$4.50 per mile)**

### **Precinct 4 -**

**\$128 price per ton delivered to 204 E. Spencer Bangs, TX.**

**(Based on 25 ton load - 156 miles at \$4.50 per mile)**

**JLB CONTRACTING**

**Part of TexasBit, a CRH Company**

**Terry Patterson - EZ Street Product Manager**

**817-876-8091**

**tpatterson@jlbcontracting.com**

A handwritten signature in black ink that reads "Terry Patterson".

4-15-19

April 29, 2019  
(Exhibit #5)

# INSTALLATION GUIDE

EZ Street asphalt will perform best and achieve maximum longevity if the following installation procedures are followed.



## 1 CLEAN



## 2 FILL



## 3 COMPACT

### General product description and use

EZ Street is a ready to use, high performance, polymer modified, asphalt capable of providing a cost effective, simple and permanent solution to a variety of applications including but not limited to potholes, utility cuts, joint repairs, outer edge repairs, surface patches (level course), and even small overlays. EZ Street asphalt is similar in appearance and performance to good hot mix asphalt and can be utilized in any weather condition (rain or shine, hot or cold). EZ Street asphalt has an extended stockpile life while retaining excellent workability. EZ Street asphalt requires no tack coat, can be used to patch both asphalt and concrete surfaces, and can even be applied in water! EZ Street asphalt can be opened immediately to traffic making it perfect for those inevitable "throw and go" situations! If proper installation techniques are utilized, EZ Street applications should have an equivalent or extended life expectancy in comparison to hot mix asphalt. Proper installation is the key to the longevity of any paving application and following is a brief guide to help insure the maximum performance for your EZ Street material.

### Material temperature and compaction

EZ Street asphalt can be applied when air temperatures are between 0°F and 100°F; however, EZ Street asphalt will be most pliable, workable, and compactable at air temperatures ranging from 70°F to 90°F. In the winter months, warming of the EZ Street material prior to application via a "hot box", heated dump bed, or patching truck is quite acceptable; although, it is imperative that the material temperature does not exceed 125°F. To insure optimum performance EZ Street asphalt should be applied and compacted in two inch (2") maximum lifts. A vibratory steel wheel roller

will always provide optimum results and performance; however, steel wheel or pneumatic rollers, compactor plates, wheel rolling, and hand tamping are also acceptable methods of compaction. Over compaction is rarely an issue.

### Installation procedure to achieve optimum results

EZ Street asphalt will perform best and achieve maximum longevity if the following installation procedures are followed.

1. Excavate entire failed pavement surface and unstable base material (including any "alligator" cracked areas).
2. Clean foreign debris from the area to be patched utilizing a broom or compressed air.
3. Compact sub-grade thoroughly to achieve a firm foundation. The preferred mode of base compaction would be a vibratory compactor plate or steel wheel roller; for small potholes, a hand tamp is acceptable.
4. Apply EZ Street material in maximum two inch (2") lifts.
5. Compact EZ Street after each lift utilizing vibratory compactor plate or steel wheel roller.
6. Final EZ Street lift should be placed approximately 3/4-1" higher than the desired finished surface level prior to compaction allowing for optimal compaction and secondary compaction as a result of traffic flow.

GUARANTEED PERMANENT • WORKS IN WATER • TXDOT APPROVED

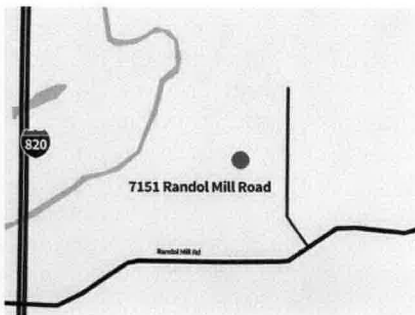

For more info contact: Terry Patterson

**817-876-8091**

tpatterson@jlbcontracting.com  
www.jlbcontracting.com

**JLB Contracting**  
7151 Randol Mill Rd  
Fort Worth, TX 76120





# STOCKPILING GUIDE

## For EZ Street Asphalt

### OVERVIEW

EZ Street is a high performance cold asphalt that is guaranteed to be permanent. EZ Street asphalt can be stockpiled in convenient locations and stored for later use. The stockpiling practices of EZ Street asphalt can have a profound impact on the ease of use and the shelf life of the product. Below is a guideline for the stockpiling and handling of EZ Street products:

### BULK STORAGE

- Stockpile height should be a maximum of ten feet high and a minimum of six feet.
- The fresher the stockpile, the easier the workability will be for EZ Street asphalt.
- Stockpiles, (5-50 tons) need to be used within six months.
- Covering large stockpiles of EZ Street asphalt is not necessary, but covering small stockpiles can add to its shelf life.
- Mixing or turning of stockpiles should be kept to a minimum: EZ Street asphalt will "crust" on the outer layer of the stockpile; this layer can be thought of as a protective layer. This crust, must be mixed in to rejuvenate the material to make it workable. We have found that the crust can be mixed in every three weeks. However, if EZ Street asphalt is being loaded out, the crust must be mixed in regardless of time spent in pile.

### BAG STORAGE

- 50 lb and 35 lb bags can be stored up to a year.
- We recommend storing bags for less than 6 months if possible, and using them before a winter season (especially if they are stored outside).
- 1 Ton bulk sacks can be stored up to 3 to 6 months.
- The best rule of thumb, is to work out of OUR stockpiles (whether it be bulk or bags) as often as possible to keep EZ Street asphalt fresh and pliable.

FOR SPECIFIC APPLICATIONS, TECHNIQUES, OR PROBLEMS, PLEASE CALL



**For more info contact: Terry Patterson**

**817-876-8091**

tpatterson@jlbcontracting.com  
www.jlbcontracting.com

**JLB Contracting**  
7151 Randol Mill Rd  
Fort Worth, TX 76120

**GUARANTEED PERMANENT • WORKS IN WATER • TXDOT APPROVED**

**JLB Contracting, LLC**

P.O. Box 24131

Fort Worth, Texas 76124



SHARON FEAGUSON  
ADD 5. Broadway, STE 101  
Brownwood, TX. 76801

FILED FOR RECORD  
TIME 3:17 PM

APR 18 2019

Sharon Feaguson, Brown County Clerk  
Deputy Sharon Feaguson